

# BTF043B-AWR\$



## ● Feature

1. 4.3" TFTLCD
2. Resolution:480\*272
3. DisplayType:TFT/Normally/White/Transmissive
4. Interface Type:24-BIT RGB
5. Drive IC:ILI6480BQ
6. Surface Luminance:400cd/m<sup>2</sup>
7. Top:-20°C~70°C
8. Support Resistive Touch Panel



## ● Mechanical Data

1. Module(WxHxT)(mm):105.5\*67.2\*4.10
2. Active Area(mm):95.04\*53.86
3. LED Numbers:10 LEDs

## ● Mechanical Drawing

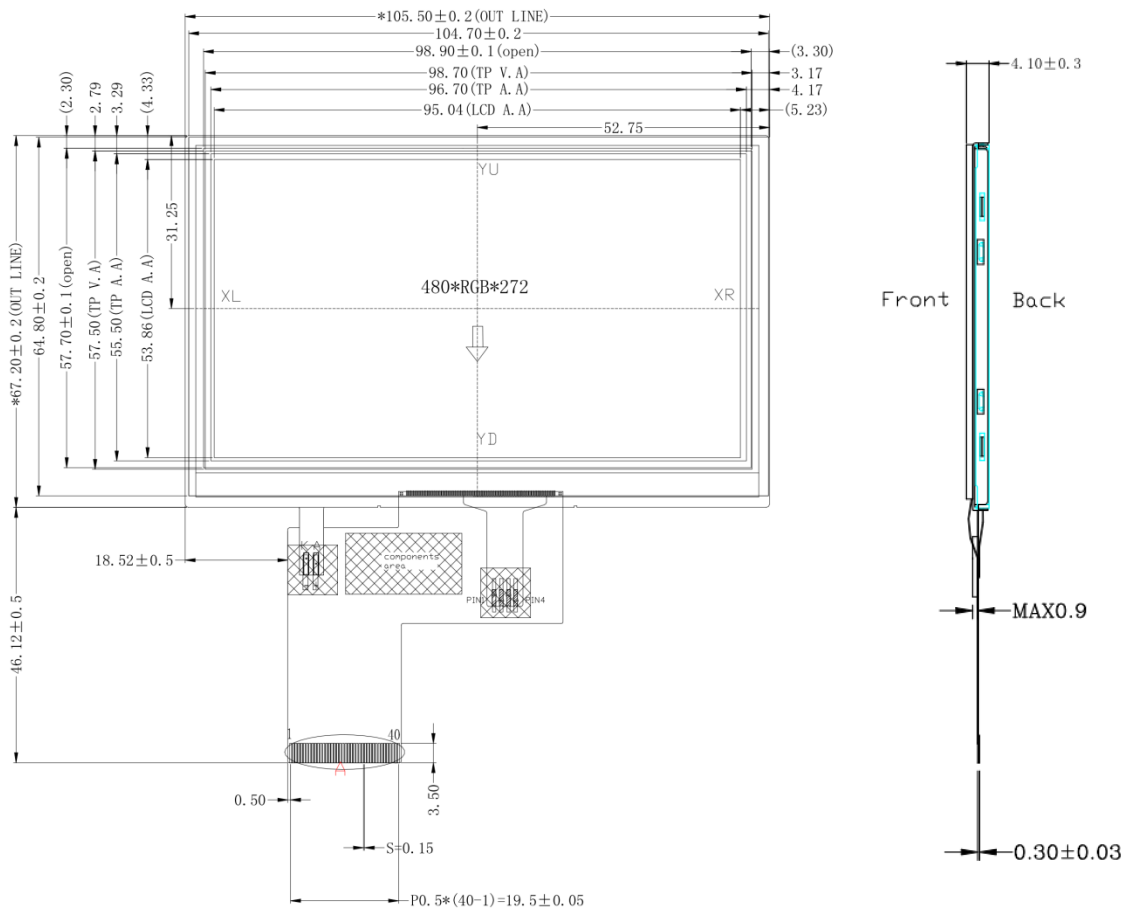

## ● Interface Pin Function

Pin No.	Symbol	Description
1	VLED-	Cathode of LED backlight
2	VLED+	Anode of LED backlight
3	GND	Power ground
4	VDD	Power supply
5~12	R0~R7	8-bit digital Red data input,
13~20	G0~G7	8-bit digital Green data input,
21~28	B0~B7	8-bit digital Blue data input,
29	GND	Power ground
30	DCLK	Clock signal; latching data at the falling edge
31	DISP	Display control / standby mode selection. DISP = "Low" : Standby; DISP = "High" : Normal display(Default)
32	HSYNC	Horizontal sync signal; negative polarity
33	VSYNC	Vertical sync signal; negative polarity
34	DE	Data input enable. Active High to enable the data input.
35	NC	No connection.
36	GND	Power ground
37	XR	TP pin.
38	YD	TP pin.
39	XL	TP pin.
40	YU	TP pin.

## ● Electrical Characteristics

Item	Symbol	Min	Typ.	Max	Unit	Applicable terminal
Supply Voltage for Analog	VDD	3.0	3.3	3.6	V	
Supply Voltage for Logic	VDD	3.0	3.3	3.6	V	
Input Voltage	V <sub>IL</sub>	GND	-	0.3VDD	V	
	V <sub>IH</sub>	0.7 VDD	-	VDD		
Input leakage Current	I <sub>LKG</sub>	-1		1	μA	